

# IDEAS TO PLACE LIGHTING DRIVERS

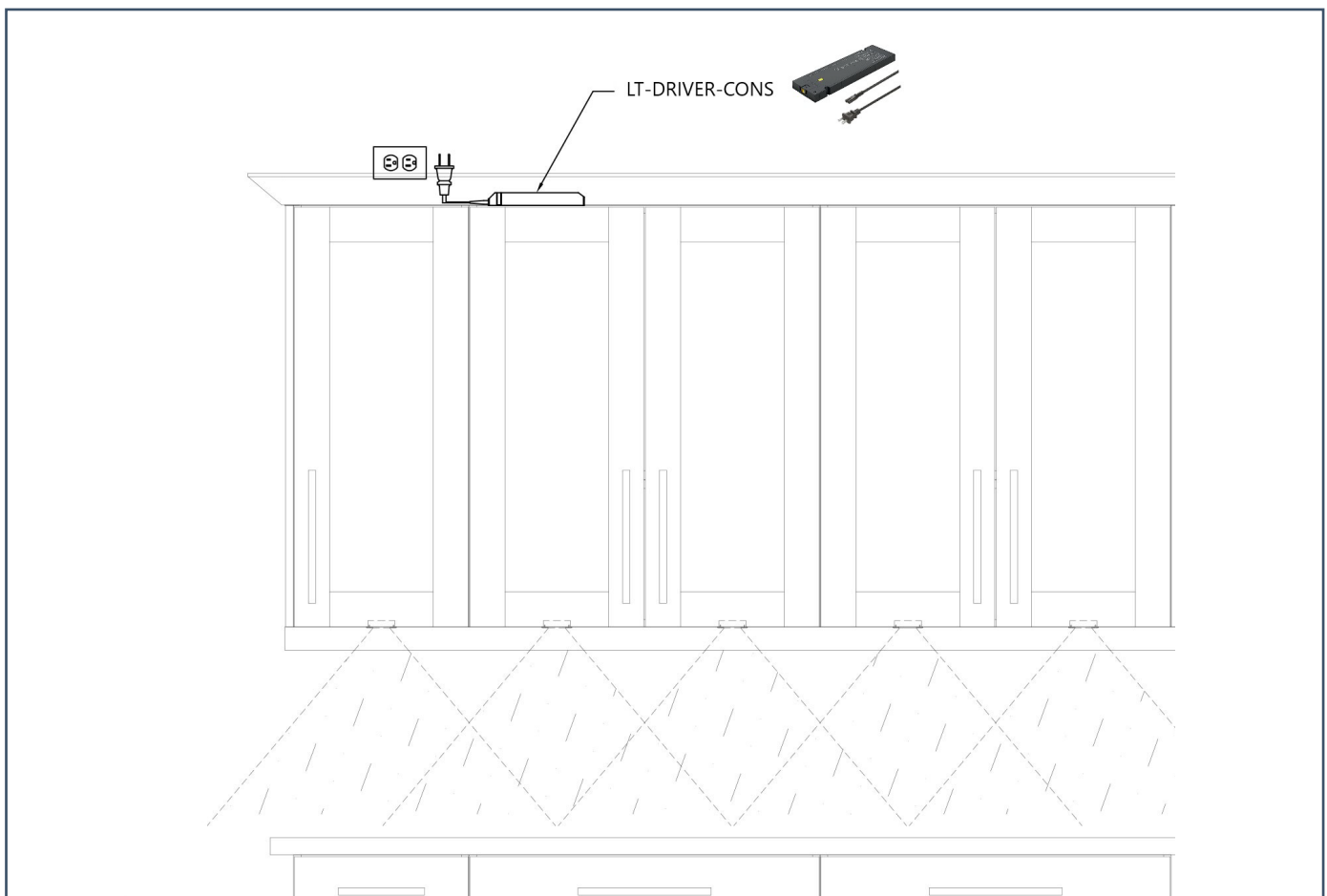

The driver location will be determined by the layout of the kitchen, house layout, and if you can add or move existing plugs and switches. The driver can be placed in several areas including on top of a wall cabinet behind molding, inside a hood cabinet, in the toe base area of a base cabinet, or behind a reduce drawer box. You may even be able to locate the driver in an attic or below a floor joist. Although this is a plug and play system an electrician may need to run wires between wall switches and driver if you are using a dimmable wall switch. If you are using a toggle / rocker switch to power the lights, then the electrician will run wires between the wall switch and plug. If you want to power the lights with cabinet switches, then all you need is a plug with the constant driver. All the above must be considered when determining the driver placement, which is why this needs to be discussed between the installer, designer, and electrician before the cabinets are ordered.

## PLACEMENT OPTION 1: DRIVER ABOVE UPPERS



# IDEAS TO PLACE LIGHTING DRIVERS



## PLACEMENT OPTION 2: DRIVER INSIDE HOOD

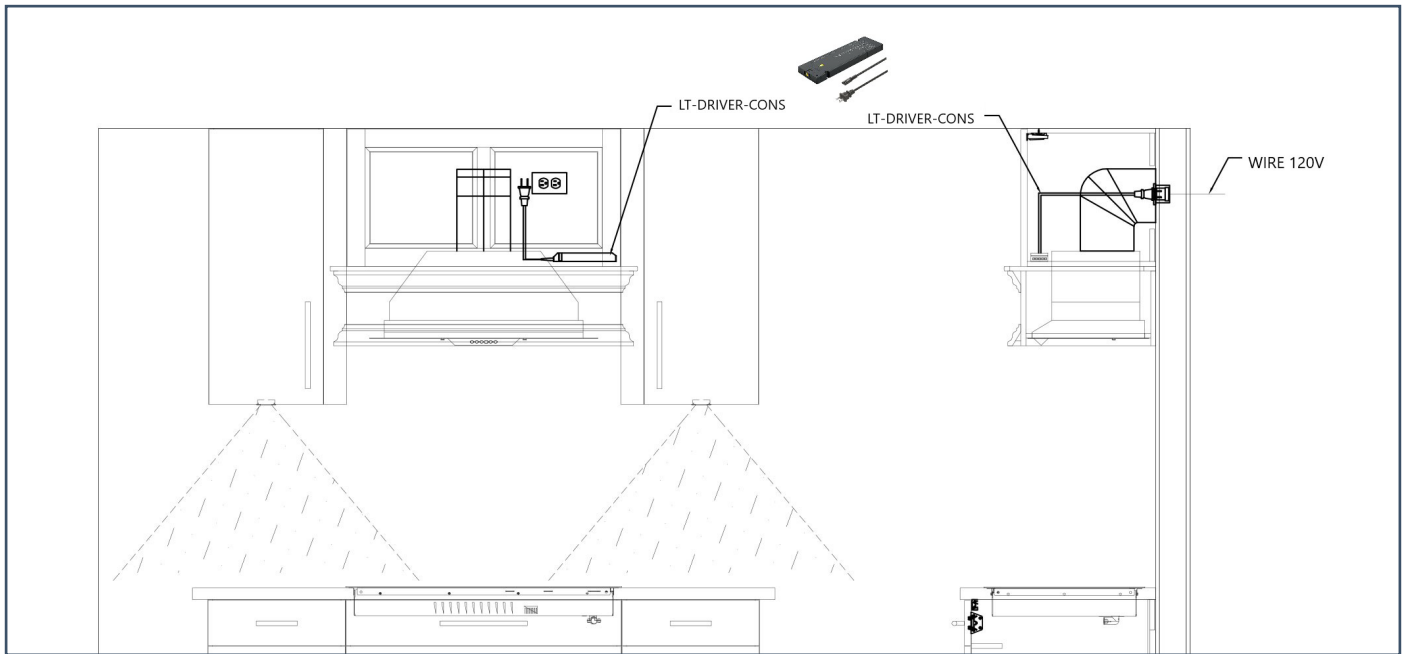

## PLACEMENT OPTION 3: DRIVER IN TOE BASE

