

WALL MOUNT VANITY HARDWARE ADJUSTMENT



Vanity Base Wall Mount Cabinets have Libra H7 hanger system installed.

During installation, this hardware can easily be adjusted to attain the desired height and depth, and to lock it in place. Below are diagrams of how to perform these simple adjustments.



Vertical

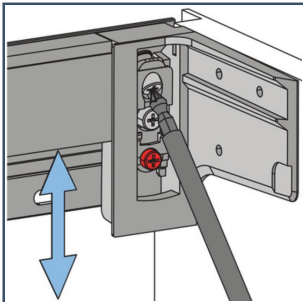

- 33/64" (13mm) vertical adjustment
- Range of motion may be limited by counter top
- Use to raise, lower, or level the cabinet left to right

Horizontal

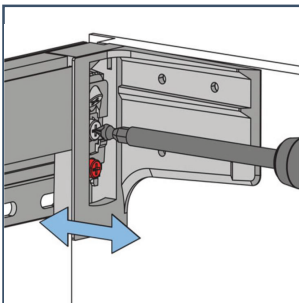

- 15/32" (12mm) horizontal adjustment
- Use to pull the cabinet towards the supporting wall

Anti-Turnover Locking

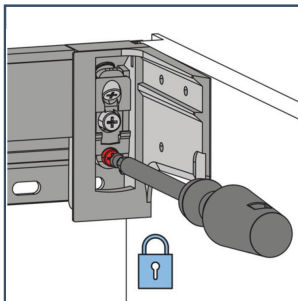

- Stop screwing the red bolt when it touches the wall rail